



## Whitchurch Gardens

Edgware

Offers over £975,000

A six bedroom house available on a quiet residential road with Davidson Frost-Wellings.

On the ground floor the house has a double reception room, open plan kitchen/dining room, a guest WC and a downstairs bedroom with en suite bathroom. Upstairs the house has four double bedrooms, an additional single bedroom and a family bathroom.

The rear garden is nearly 100' long with a spacious patio, a lawn and mature borders with two sheds.

Harrow Council Tax Band E.

### Viewing

Please contact our Davidson Frost-Wellings Office on 020 8954 8806 if you wish to arrange a viewing appointment for this property or require further information.

- Six bedrooms
- Multiple reception rooms
- Quiet residential road
- Large private garden
- Off street driveway parking
- Semi detached freehold





Floor Plan

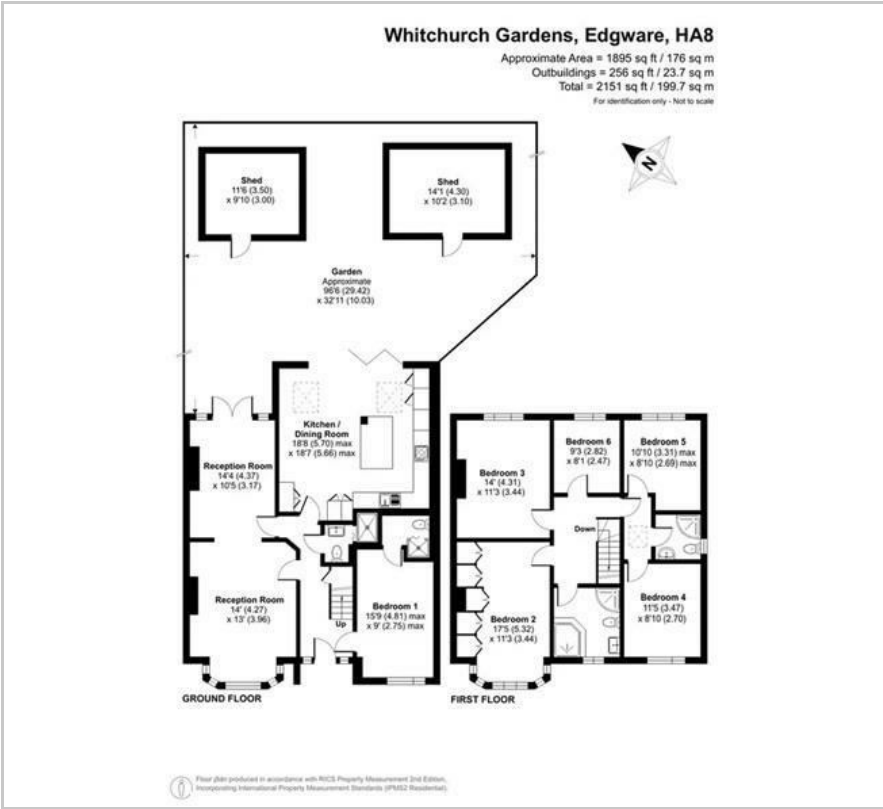

Area Map

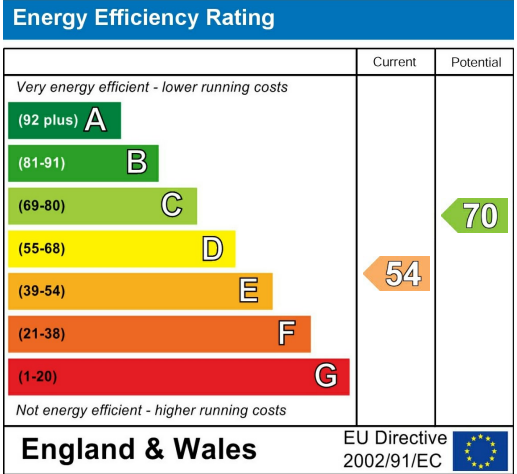
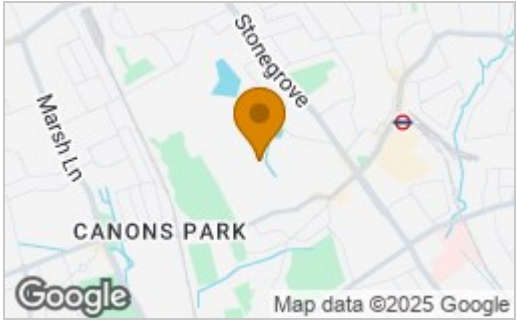

These particulars, whilst believed to be accurate are set out as a general outline only for guidance and do not constitute any part of an offer or contract. Intending purchasers should not rely on them as statements of representation of fact, but must satisfy themselves by inspection or otherwise as to their accuracy. No person in this firms employment has the authority to make or give any representation or warranty in respect of the property.